



LIVE THE BRAAI LIFE

CITI CHEF 40

MODEL No: 5610
28mbar & 50mbar



USER INSTRUCTIONS

GB DE DK ES FR IT NL NO PL SE

CAUTION



Provide ample ventilation. This gas appliance consumes air (oxygen). Do not use this appliance in an unventilated space to avoid endangering your life. If still more gas appliances and/or occupants using gas are added to the space, additional ventilation must be provided.

IMPORTANT

Read these instructions carefully so as to familiarise yourself with the appliance before fitting the appliance to a gas cylinder. Retain these instructions for future reference.

1. General

- The appliance complies with BS EN 498:2012, BS EN 484:1998 and SANS 1539:2012.
- This appliance shall only be used with an approved hose and regulator.
- The hose and regulator can be connected to a gas cylinder, a gas cartridge, a CADAC Power Pak 500 which is a unit that takes two gas cartridges or a vertical EN417 regulator assembly connected to a EN417 threaded gas cartridge. (Not supplied with the appliance).
- Gas appliances require ventilation for efficient performance and to ensure the safety of users and other persons in close proximity as the gas appliance consumes oxygen.
- Only to be used with a gas cylinder that does not exceed 500mm in height (regulator not included) and 400mm in width.
- When using a pot, the minimum recommended pot size is 150mm and maximum recommended size is 300mm.
- This appliance must be kept away from flammable materials during use.
- **Use Outdoors Only.**
- **Warning:** Accessible parts may be very hot. Keep young children away.

PRODUCT No. 5610-20				
Country of use	DK, FI, NO, NL, SE, AT, DE, SI	BE, ES, FR, IE, IT, PT, GB, CH	PL	AT, DE
Appliance Categories	I3B/P (30)	I3+ (28-30/37)	I3B/P (37)	I3B/P (50)
Allowable gases and operating pressure	Butane @ 28-30mbar Propane @ 28-30mbar Butane/Propane mixtures @ 28-30mbar (S. Africa - LPG @ 2,8kPa)	Butane @ 28-30mbar Propane @ 37mbar	Butane @ 37mbar Propane @ 37mbar Butane/Propane mixtures @ 37mbar	Butane @ 50mbar Propane @ 50mbar Butane/Propane mixtures @ 50mbar
Nominal usage	Butane - 196 grams/hour	Butane - 196 grams/hour	Butane - 196 grams/hour	Butane - 196 grams/hour
Gross nom. heat input	2.7 kW	2.7 kW	2.7 kW	2.7 kW
Jet number	84		79	74
Gas supply sources:				
a)	A refillable gas container not exceeding 11kg and complying with local regulation in force.			
b)	CA 445/CA 500 Cadac or equivalent EN417 compliant disposable cartridge with CADAC Power Pak 500.			

Country name abbreviations			
AT=Austria	DK=Denmark	GB=UnitedKingdom	NO=Norway
BE=Belgium	ES=Spain	IE=Ireland	PL=Poland
CH=Switzerland	FI=Finland	IT=Italy	PT=Portugal
DE=Germany	FR=France	NL=Netherlands	SE=Sweden
SI=Slovenia			

2. Safety information

Hose

- The hose must be checked for wear or damage before every use and before connecting to the gas container.
- Do not use the appliance if it has a damaged or worn hose. Replace the hose.
- Do not use an appliance that is leaking, damaged or which does not operate properly.
- The minimum hose length is 600mm and it is recommended that the maximum hose length should not exceed 1.5m.

Gas Container

- This appliance must only be used with an approved hose and regulator. (A 2.8kPa hose and regulator supplied only in South Africa)
- Ensure that the gas container is fitted or changed in a well-ventilated location, preferably outdoors, away from any sources of ignition such as naked flames, pilots, electric fires and away from other people.
- Keep gas containers away from heat and flame. Do not place on a stove or any other hot surface.
- Refillable cylinders are to be used only in the upright position so as to ensure proper fuel withdrawal. Failure to adhere to this may cause liquid discharge from the gas container resulting in a dangerous operating condition.
- Do not try to remove the cylinder whilst the unit is in operation.
- The gas cylinder must be disconnected from the appliance after use or when in storage.
- Not for use with a remote gas supply.

Assembly and use

- Use only on a firm level surface.
- Do not move the appliance during use.
- Ensure the appliance is used away from flammable materials. Minimum safe distances are: Above the appliance 1.2m. At the rear and sides 600mm.
- **WARNING:** Accessible parts may be very hot, the use of protective gloves is recommended. Keep young children away.
- **Use outdoors only!**
- Light back
- In the event of light back (where the flame burns back and ignites inside the burner or venturi housing), immediately turn off the gas supply by firstly closing the control valve on the gas cylinder and then the appliance valve. After the flame is extinguished, remove the regulator and check the condition of the seal; replace the seal if in doubt. Re-light the appliance.
- Should the flame persistently light back, return the product to your authorized CADAC repair agent.
- Leaks
- If there is a leak on your appliance (smell of gas), turn off the cylinder valve and take it outside immediately into a well-ventilated flame-free location where the leak may be detected and stopped. If you wish to check for leaks on your appliance, do it outside. Do not try to detect leaks using a flame; use soapy water.
- The correct way is to smear the joints with soapy water. If a bubble or bubbles form then there is a gas leak. Immediately turn off the gas supply firstly by closing the control valve on the gas container and then the appliance valve. Check that all the connections are properly fitted. Re-check with soapy water.
- If a gas leak persists, return the product to your CADAC dealer for inspection/repair.

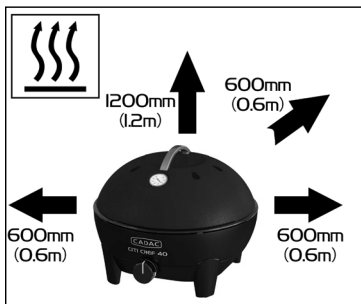

PARTS LIST:

- A. Dome
- B. Chef Pan 36
- C. Pizza Stone
- D. Reversible Grill
- E. BBQ Grid
- F. Pot Stand
- G. Fat Pan
- H. Burner Base



The following surfaces are not included and are sold separately: Chef pan 36 (B), Pizza Stone (C), Reversible Grill (D).

3. Operating the Appliance

- When operating this appliance, please take care to ensure that all parts are in good working order and that you have checked for any gas leaks before lighting the appliance.
- Items can simply be placed on top of each other.
- When using the Reversible Grill Plate (D) please note a flame tamer should be used with this cooking surface as to protect the surface from being exposed to too much heat. See below figure for your reference.

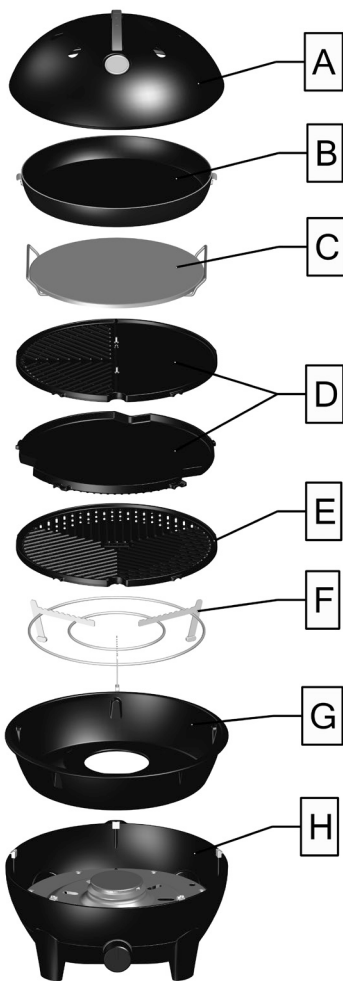
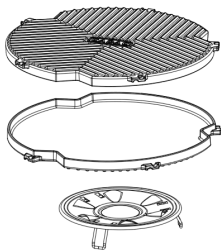

4. Fitting and Changing the Gas Cylinder

- After use, turn off the control knob to the off position ("•" - turn fully clockwise) and close the gas cylinder valve.
- Ensure that the gas cylinder is fitted or changed in a well-ventilated location away from any source of ignition, such as naked flames and away from other people.
- Do not smoke while changing the cylinder.
- When you need to replace your empty cylinder, make sure that the gas is closed at the cylinder valve.
- Remove the regulator from the empty cylinder.
- Avoid twisting the hose whilst connecting the regulator to the new/replacement cylinder.
- Blow out any dust from the cylinder opening to prevent possible blockage of the jet.
- Place the full cylinder in its allocated space and attach the regulator connection to the cylinder.
- Ensure that a complete gas seal has been made (check for the smell of gas around the connection joint). Do not check for leaks with a naked flame. Use warm soapy water only, applied to the joints and connections of the appliance. Any leakage will show up as bubbles around the leakage area. If you are in doubt, contact your nearest stockist.

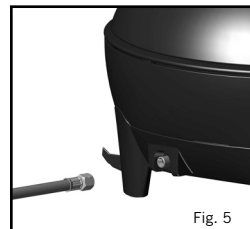

Fig. 5

5. Cleaning

- Allow the appliance to cool down before you clean it.
- Use a damp cloth wrung out in a solution of soapy water to clean the exterior and cylinder storage area.
- The grill plate is coated with a tough durable ceramic non-stick coating that has been used with great success on some of the best cookware in the world. Never the less, taking care of it can help you to enjoy extra years of healthy, easy, non-stick cooking.
- Whilst the non-stick coating is very durable, it can easily be damaged by the use of metal cooking utensils. It is therefore recommended that only plastic or wooden utensils be used when cooking.
- Always allow the grill plate to cool before immersing it in water.
- Make sure that no water gets onto the burners or pilot/light area. Wipe the appliance completely dry before use.
- Do not use abrasive cleaners as they may damage the surfaces.
- Clean the appliance after each use. After cleaning recondition the surface with a light wipe of oil.
- Do not use any high-pressure steam equipment or a water jet to clean the appliance.
- Remove the fat from the moat of the Fat Pan.
- Note: For stubborn stains, oven cleaner may be used.

6. Maintenance

- If you clean and maintain your appliance on a regular basis, the life of your appliance will extend and possibility of problems will decrease.

In case of a spattering flame or jet blockage:

- Clean your burner ports in case of an over spill.
- CADAC recommends to clean or replace the jets every six (6) months to ensure continued efficient operation of your appliance.
- This may be done by removing the jet using standard tools and blow any dirt from the jet, alternatively, you may purchase new jets from your local CADAC store. Do not attempt to clean the jet mechanically.

Service intervals and servicing:

- CADAC recommends the service of your appliance to be every twelve (12) months by a service agent to ensure continued efficient operation.
- Note: Any technical work on the appliance should only be performed by a qualified technician.
- Check your gas hose and connections regularly for and signs of leaks and every time the gas cylinder is re-filled.
- Should the appliance operate abnormally after storage and all checks have not isolated the problem, the venturi may be blocked. A blocked venturi would be indicated by a weaker yellowish flame or no flame at all in extreme cases. Under these circumstances it will be necessary to remove the burner and to check and thoroughly clean out any foreign matter which may have gathered in the venturi.

7. Storage

- Always allow the unit to cool down before storing.
- Turn off the cylinder valve supplying gas to the appliance, if you remove the cylinder, then disconnect the cylinder.
- Store cylinder in a well-ventilated area away from combustible material. Storage of cylinders should preferably be outdoors and must NOT be in a basement.

8. Returning the appliance for Repair, Service & Warranty

- Do not modify the appliance. This may cause the appliance to become unsafe. Any modifications will render the CADAC warranty null and void.
- If you cannot rectify any fault by following these instructions, contact your local CADAC distributor for advise, inspection or repair instructions.
- Please keep all proof of payments and the installation certificate for warranty purposes, if these cannot be supplied then all warranties will be considered void.
- This CADAC appliance is guaranteed by CADAC for a period of 5 years against factory fault.

9. Spares & Accessories

Always use genuine CADAC spares as they have been designed to give optimum performance.

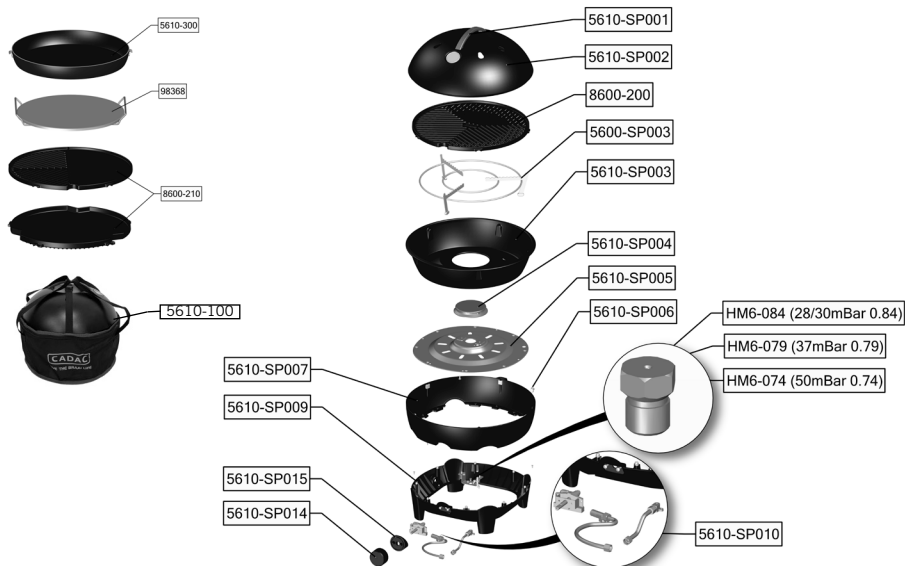

10. Warranty

CADAC (Pty) Ltd hereby warrants to the ORIGINAL PURCHASER of this CADAC gas appliance, that it will be free of defects in material and workmanship from the date of purchase as follows:

Valves:	5 Years
Plastic parts:	No Warranty
Enamel parts:	5 Years
Burners:	1 Year

The warranty will only apply if the unit is assembled and operated in accordance with the printed instructions.

CADAC may require reasonable proof of your date of purchase. THEREFORE, YOU SHOULD RETAIN YOUR SALES SLIP OR INVOICE.

This Limited Warranty shall be limited to the repair or replacement of parts that prove defective under normal use and service and which on examination shall indicate, to CADAC's satisfaction, they are defective. Before returning any parts, contact the customer service representative in your region using the contact information provided with your manual. If CADAC confirms the defect and approves the claim, CADAC will elect to replace such parts without charge. CADAC will return parts to the purchaser, freight or postage prepaid.

This Limited Warranty does not cover any failures or operating difficulties due to accident, abuse, misuse, alteration, misapplication, vandalism, improper installation or improper maintenance or service, or failure to perform normal and routine maintenance, including but not limited to damage caused by insects within the burner tubes, as set out in this owner's manual. Deterioration or damage due to severe weather conditions such as hail, hurricanes, earthquakes or tornadoes, discoloration due to exposure to chemicals either directly or in the atmosphere, is not cover by this Limited Warranty.

There are no other express warrants except as set forth herein and any applicable implied warranties of merchantability and fitness are limited in duration to the period of coverage of this express written Limited Warranty. Some regions do not allow limitation on how long an implied warranty lasts, so this limitation may not apply to you.

CADAC is not liable for any special, indirect or consequential damages. Some regions do not allow the exclusion or limitation of incidental or consequential damages, to this limitation or exclusion may not apply to you.

CADAC does not authorize any person or company to assume for it any obligation or liability in connection with the sale, installation, use, removal, return, or replacement of its equipment; and no such representations are binding on CADAC.

This Warranty applies only to products sold at retail.

To enjoy and ensure longevity of your CADAC product, please refer to the cleaning and maintenance section of the user manual with particular attention to the care of the Stainless Steel.